

| (1) | (2) | (3) | (4) | (5) | (6) | (7) | (8) |
|--------|------|-------|------------------|----------|---|-----|------|
| ILLUS. | | | | | | | QTY |
| (a) | (b) | SMR | NATIONAL | PART | DESCRIPTION | U/M | INC |
| FIG. | ITEM | CODE | STOCK | NUMBER | FSCM | | IN |
| NO. | NO. | | NUMBER | | USABLE ON CODE | | UNIT |
| | | | | | 1801-BODY, CAB, HOOD AND HULL ASSEMBLIES (CONT'D) | | |
| 134 | 9 | PAOZZ | 9390-00-737-3301 | 7373301 | 19207 RUBBER CHANNEL: GLASS REGULATOR RUBBER | EA | 1 |
| 134 | 10 | PAOZZ | 2510-00-179-5708 | 10906350 | 19207 FILLER | EA | 1 |
| 134 | 11 | PAOZZ | 2510-00-737-3296 | 7373296 | 19207 CHANNEL: CAB DOOR GLASS REGULATOR, LEFT | EA | 1 |
| 134 | 11 | PAOZZ | 2540-00-737-3297 | 7373297 | 19207 CHANNEL: CAB DOOR REGULATOR, RIGHT | EA | 1 |
| 134 | 12 | PAOZZ | 5305-00-145-0602 | 8743910 | 19207 SCREW, SELF-LOCKING | EA | 1 |
| 134 | 13 | PAOZZ | 2540-00-737-3304 | 7975607 | 19207 HANDLE, WINDOW REGULATOR | EA | 1 |
| 134 | 14 | PAOZZ | 5330-00-621-2565 | 7397852 | 19207 WASHER, SPACER, HANDLE | EA | 1 |
| 134 | 15 | PAOZZ | 2540-00-562-0422 | 7529309 | 19207 FASTENER, REGULATOR | EA | 2 |
| 134 | 16 | PAOZZ | 2540-00-693-0603 | 7373290 | 19207 REGULATOR, GLASS, RH (USED ON DOOR, NSN 2510-00-737-3294, ONLY) | EA | 1 |
| 134 | 16 | PAOZZ | 2540-00-693-0602 | 7373289 | 19207 REGULATOR, GLASS, LH (USED ON DOOR, NSN 2510-00-737-3293, ONLY) | EA | 1 |
| 134 | 17 | PAOZZ | 5305-00-531-0451 | 8743909 | 19207 SCREW, ASSEMBLED WASHER | EA | 1 |
| 134 | 18 | PAOZZ | 2540-00-797-5609 | 7975609 | 19207 HANDLE ASSEMBLY, DOOR | EA | 1 |
| 134 | 19 | PAOZZ | 5305-00-483-2339 | 8743908 | 19207 SCREW, MACHINE | EA | 4 |
| 134 | 20 | PAOZZ | 2540-00-741-0715 | 7410715 | 19207 HANDLE, DOOR: OUTSIDE | EA | 1 |
| 134 | 21 | PAOZZ | 5305-00-177-5312 | 420982 | 21450 SCREW, ASSEMBLED WASHER | EA | 10 |
| 134 | 22 | PAOZZ | 2540-00-737-3277 | 7373277 | 19207 LOCK, CAB DOOR: REMOTE CONTROL, RIGHT (USED ON DOOR, NSN 2510-00-737-3294, ONLY) | EA | 1 |
| 134 | 22 | PAOZZ | 2540-00-737-3276 | 7373276 | 19207 LOCK, CAB DOOR: LEFT (USED ON DOOR, NSN 2510-00-737-3293, ONLY) | EA | 1 |
| 134 | 23 | PAOZZ | 5305-00-696-5285 | 187992 | 21450 SCREW, ASSEMBLED WASHER | EA | 2 |
| 134 | 24 | PAOZZ | 2540-00-754-0419 | 7540419 | 19207 WEDGE, DOOR, DOVETAIL: MAKE (USED ON VEHICLES THROUGH SERIAL NUMBER M15229) | EA | 1 |
| 134 | 25 | PAOZZ | 5365-00-533-3409 | 7529300 | 19207 SHIM | EA | 1 |
| 134 | 26 | PAOZZ | 5305-00-078-7021 | 8743911 | 19207 SCREW, MACHINE | EA | 16 |
| 134 | 27 | PAOZZ | 5340-00-737-3285 | 7373285 | 19207 HINGE,BUTT: CAB DOOR, RIGHT (USED ON DOOR, NSN 2510-00-737-3294, ONLY) (COMPONENTS SAME AS HINGE, NSN 5340-00-737-3284) | EA | 2 |
| 134 | 27 | PAOZZ | 5340-00-737-3284 | 7373284 | 19207 HINGE, BUTT: CAB DOOR, LEFT, W/PIN, (USED ON DOOR, NSN 2510-00-737-3293, ONLY) | EA | 2 |
| 134 | 28 | PAOZZ | 5315-00-338-1621 | 7539131 | 19207 PIN, STRAIGHT | EA | 1 |
| 134 | 29 | PAOZZ | | 7529301 | 19207 LEAF | EA | 1 |

TM 9-2320-209-34P

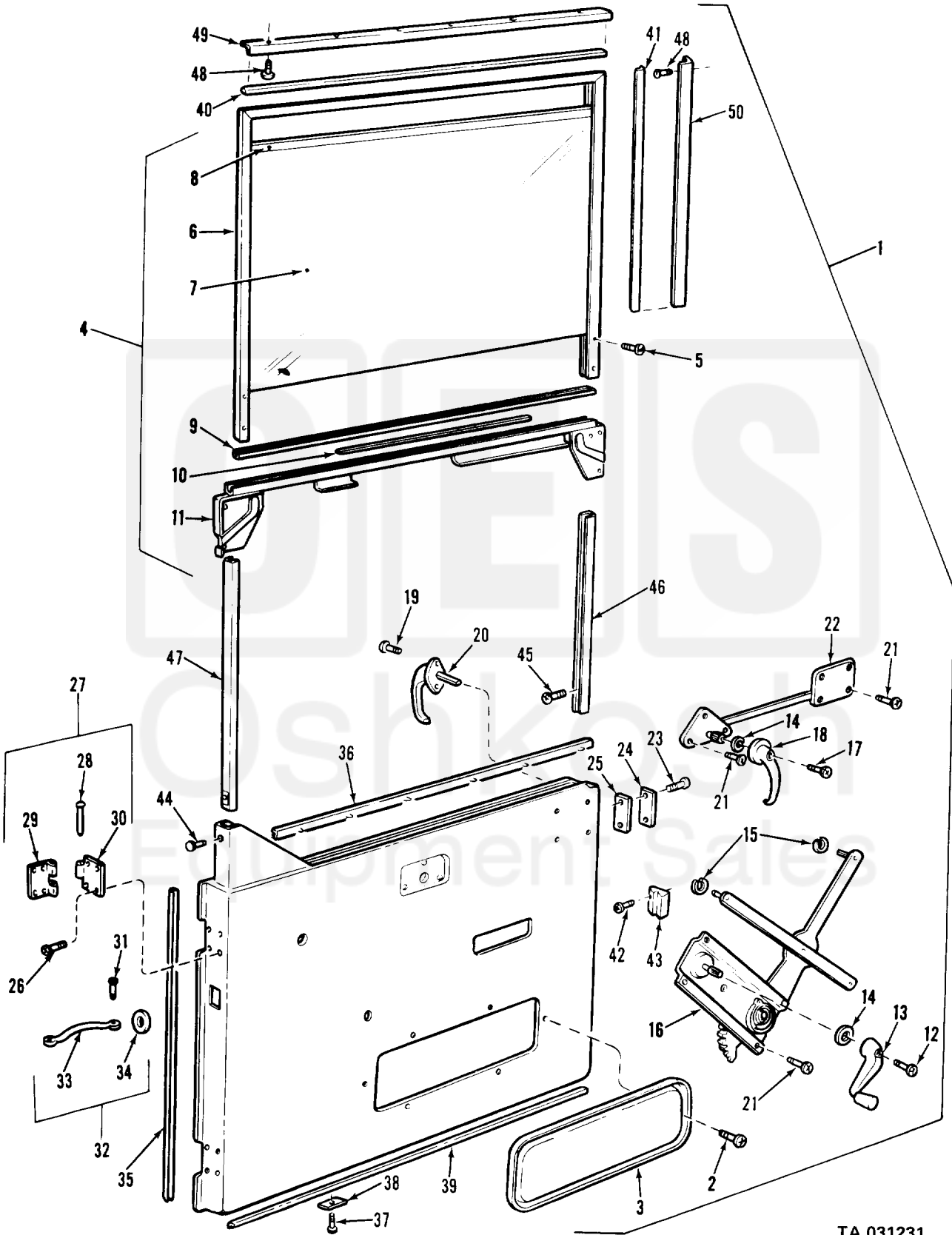

TA 031231

Figure 134. Cab door.